

Front Bench Seat Back
1/2" thick

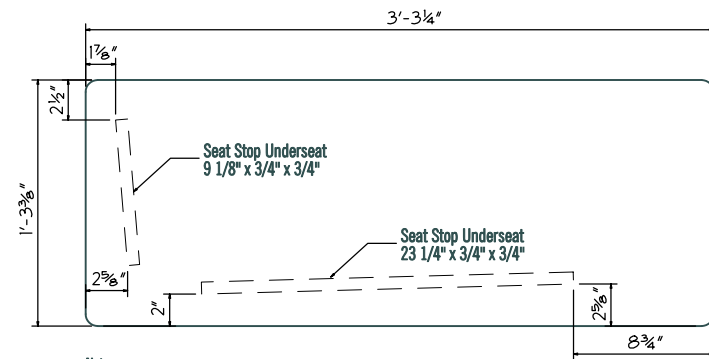

Note:
Seat Covered in 4" Foam

Front Bench Seat Top View
1/2" thick

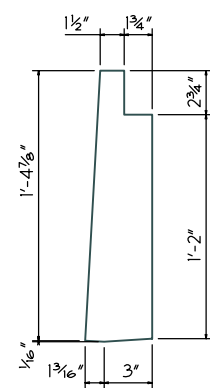

Left Bench Support Cover Piece
1/4" thick

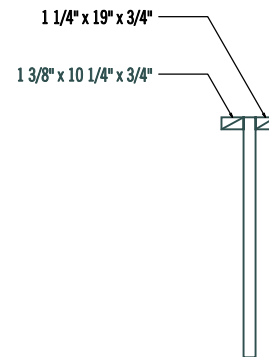

Left Bench Support (View Looking Front)
3/4" thick (Orig 1/2" ?)

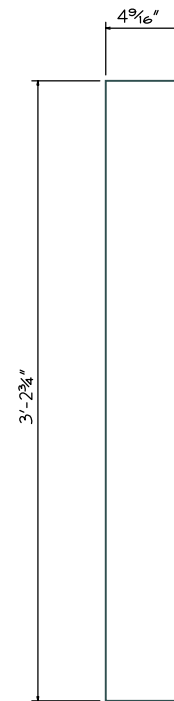

Between Drivers Seat/First Bench
1/2" thick

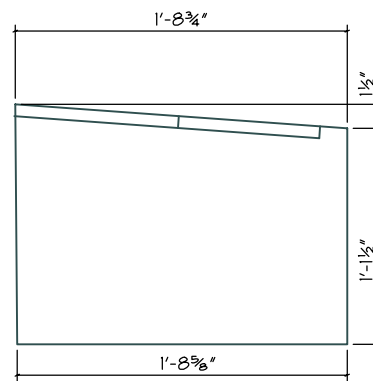

Left Bench Support (Side View)
3/4" thick (Orig 1/2" ?)

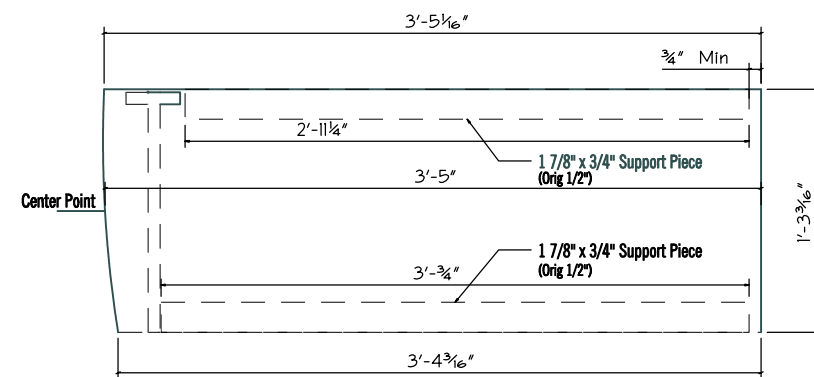
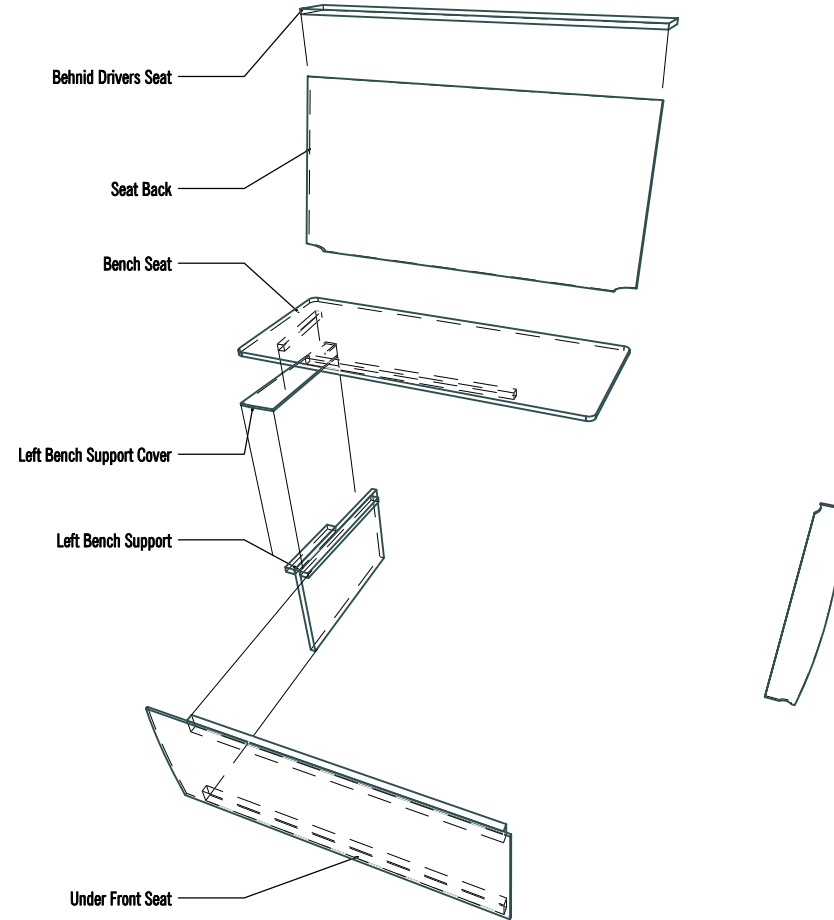

Under Front Seat
1/4" thick

NOTE:

The drawings in this set represent my best attempt to recreate the interior of my '85 Kombi. I measured my existing cabinets as closely as I felt was warranted. These drawings may be printed out and used to create cabinets of your own. Please double check these measurements against the installation location to insure a proper fit. If you attempt to disseminate this information please maintain the format as presented.

Front Cabinets

E-Z Camper Interior

DRAWN BY: KEVIN GUARNOTTA
FROM: 1985 VW Kombi w/EZ-Camper Interior
SHEET #

REV: 1.0